

3 Dene Road, Andover, SP10 2AA
£1,300

PROPERTY DESCRIPTION BY Ella Flint

Graham & Co offer to the market a three bedroom end of terrace family home, being just a stones throw away from Andover Town Centre.

The property comprises of entrance porch, entrance hall, cloakroom, kitchen and lounge. Upstairs has a family shower room, three bedrooms, in which the master houses a brand new en-suite bathroom. Outside has a driveway and low maintenance rear garden.

Dene Road, SP10

Approximate Gross Internal Area = 74.5 sq m / 802 sq ft

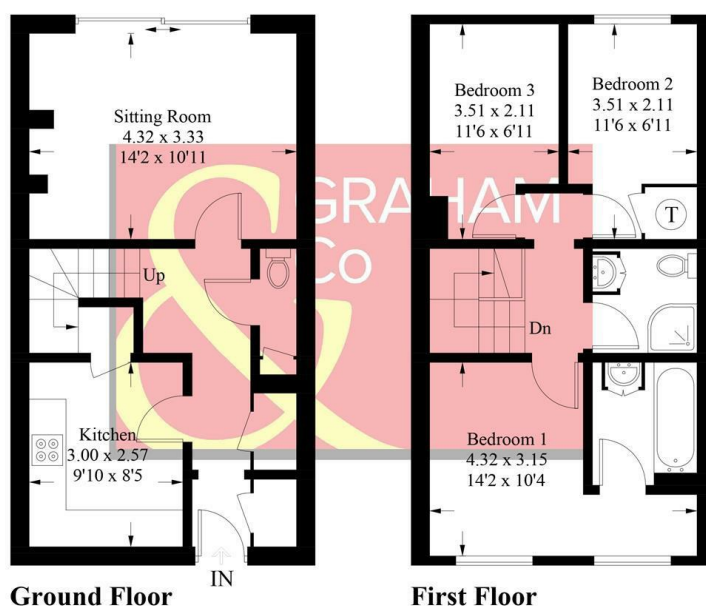

PRODUCED FOR GRAHAM AND CO

Whilst every attempt has been made to ensure the accuracy of the floorplan, measurements of doors, windows and rooms are approximate. These plans are for representation purposes only as defined by RICS Code of Measuring Practice and used as such by any prospective purchaser. © Emzo Marketing (ID916928)

DIRECTIONS

From our office head straight up towards London Street, and take the turning just before into Dene Road where the house can be found on your left.

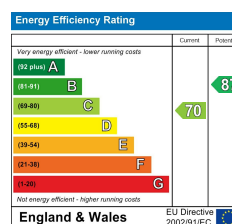

Tax Band: B



OPEN 7 DAYS

If you are considering selling your home please contact us today for your free no obligation valuation

01264 356500

IMPORTANT: we would like to inform prospective purchasers that these sales particulars have been prepared as a general guide only. A detailed survey has not been carried out, nor the services, appliances and fittings tested. Room sizes should not be relied upon for furnishing purposes and are approximate. If floor plans are included, they are for guidance only and illustration purposes only and may not be to scale. If there are any important matters likely to affect your decision to buy, please contact us before viewing the property.